

Staycell® Spray Foam Insulation Systems for the Metal Building Industry

ROOFS

@ 0.035 U-factor

STAYCELL® CLOSED-CELL & OPEN-CELL SPRAY FOAM SYSTEMS WITH OPTIONAL INTERIOR LINER PANELS

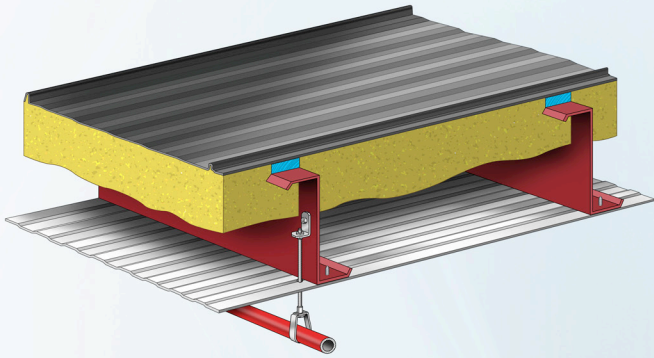

FIBERGLASS LINER SYSTEMS WITH OPTIONAL INTERIOR LINER PANELS

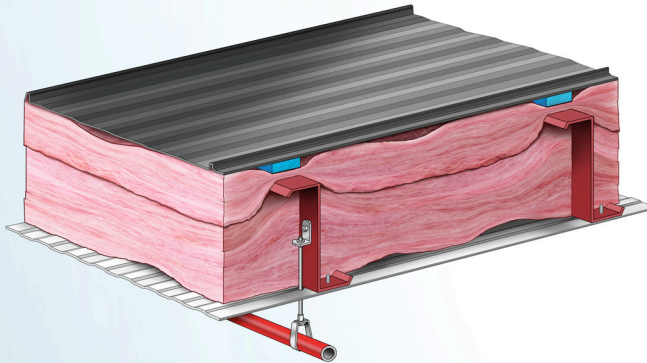

IMP PANELS

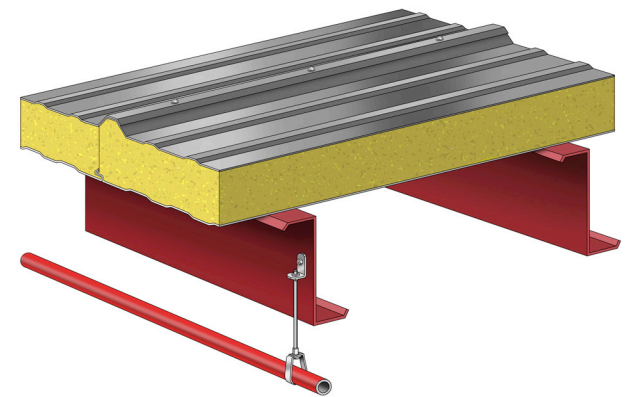

ESTIMATED DIRECT LABOR & MATERIAL COSTS PER SQ. FT.

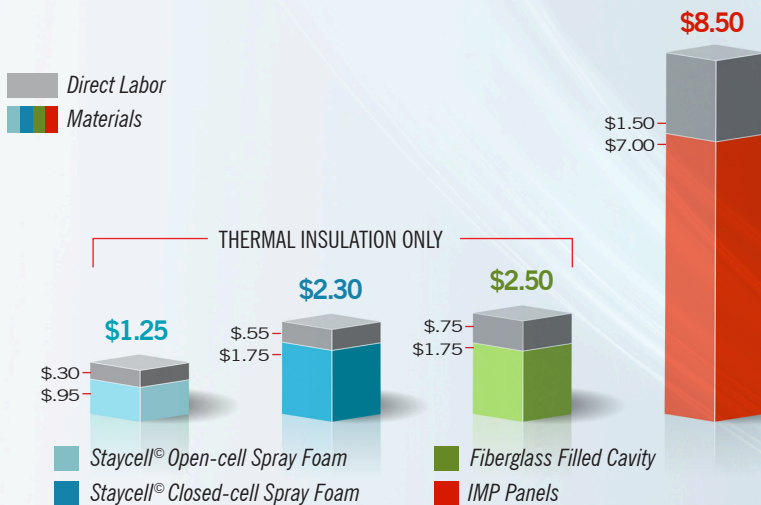

PRIMARY FEATURES AND BENEFITS COMPARED TO FIBERGLASS LINER SYSTEMS:

- Sprayed after roof installed which reduces labor and time to enclose the building
- Sprayed directly onto underside of roof panels to control condensation and moisture accumulation
- Seamless to provide a continuous air barrier and reduce energy consumption
- Continuous connections of roof panels to purlins which increases resistance to wind uplift
- Hanger installation is simplified since lower portion of purlin web is accessible

PRIMARY FEATURES AND BENEFITS COMPARED TO IMP PANELS:

- Lifting cranes are not required which provides faster/simpler installation
- Labor to air seal transitions and penetrations is minimized which improves productivity
- Roof purlins are concealed to provide improved appearance and cleanability

Costs are national averages as of January, 2024 based on direct labor costs of \$60.00 per man hour, 3% trim, 3% waste, accessories, installation of thermal spacers and air sealing of penetrations and transitions. Please contact PSI for detailed costs and energy consumption calculations.